





Sign Area: 20" X 120" = 16.6 sq. ft.
 Building Area: (13' X 22' = 260 sq. ft.)

LED illuminate Channel letters on raceway (Wall sign)
 Weights of Sign: 100 lbs Scale: 1/2"=1'

Letters: **AROI DESU**
 * 3" deep Black aluminum return
 * 1" Back trim cap
 * 3/16" White Acrylic with/ translucent vinyl surface
 * White LED internal illuminate UL list

Logo and Can. Letters: 
 * 3" deep Black aluminum return 
 * 1" Back trim cap
 * 3/16" White Acrylic with/ translucent vinyl surface
 * White LED internal illuminate UL list

Raceway: 
 * Aluminum fabricated, with Toggle switch and contents internal electrical wire and power supply UL list
 * Paint to match building Color



Building Elevation Scale: 1/3" = 10'



Existing Building Scale: NTS

Sign must be approved by the National Electrical Code, Underwriters Laboratory, and all applicable local codes. Installation Note: For installation, tenant is responsible to provide the 120 volt that run from the main power panel to behind where the sign will be install. This need to be complete prior the date the sign will be install.



3814 4th Ave s. #10
 Seattle, WA 98134
 Phone: (206)414.2131
 Direct: (206)240.1522

Job Name:
 Aroi Desu
 Address:
 3039 78th Ave SE,
 Mercer Island, WA 98040

Sign Type:
 Wall Sign
 Quality:
 One Sign

Date : 2/11/2026
 Revision: R-0
 This design presentation is the property of Spiral Signs. All rights to use, alter or reproduce are prohibited without written permission.

Client Approved
 Landlord Approved

Note: _____



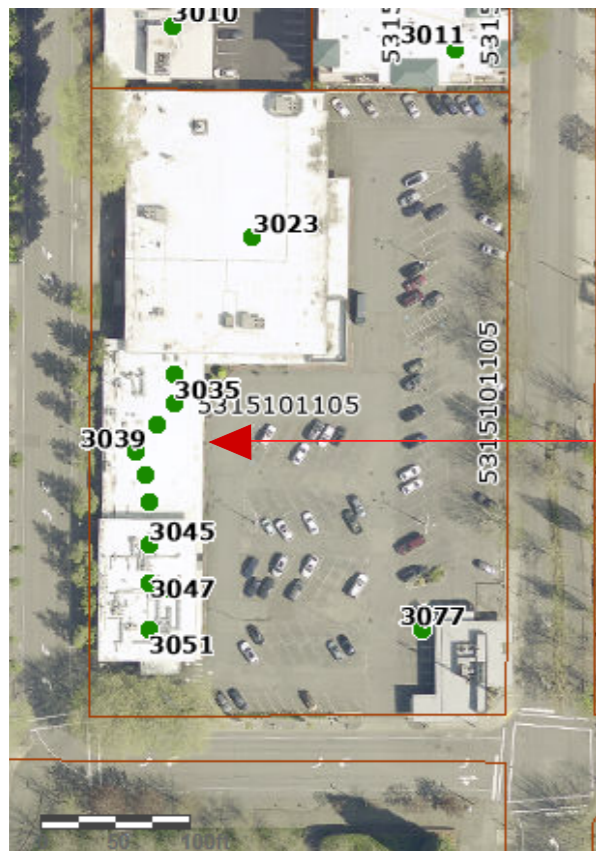

NORTH
SITE PLAN

Scale: NTS

Sign location

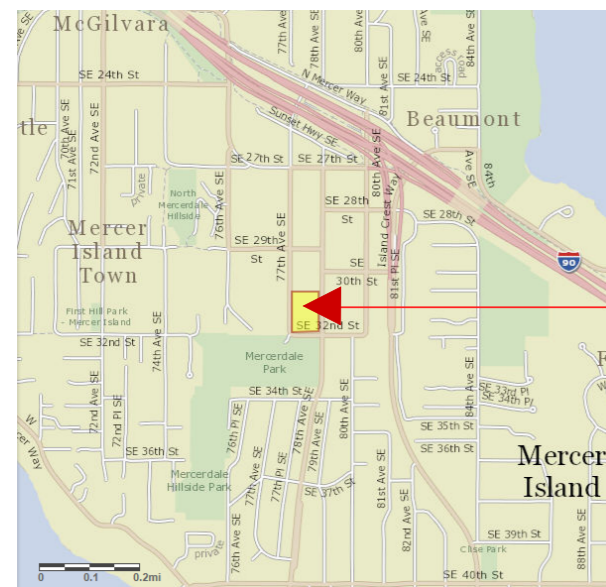

NORTH
VICINITY MAP

Scale: NTS

LED Diode Module *UL List*
 4 @ 3 -1/2" galvanize Bolt
 Mounted Direct Building
 Disconnect switch
 Electronic Power Supply *UL List*
 .40" Aluminum Return
 1"x1"x.125" Aluminum square Tube
 3/16" White Acrylic
 Trim Cap
 Rain hole

Existing Junction Box

Typical Attachment
 Scale: 1"=1'
LED System
 Input: **AC 120 Volts 20 Amp 50/60(Hz)**
 Output: **DC 12v 5 Amp max. Watts 60**

UL LISTED
 Signs Certified for US
 UL file: E321588

Sign must be approved by the National Electrical Code, Underwriters Laboratory, and all applicable local codes. Installation Note: For installation, tenant is responsible to provide the 120 volt that run from the main power panel to behind where the sign will be install. This need to be complete prior the date the sign will be install.



3814 4th Ave s. #10
 Seattle, WA 98134
 Phone: (206)414.2131
 Direct: (206)240.1522

Job Name:
 Aroi Desu
 Address:
 3039 78th Ave SE,
 Mercer Island, WA 98040

Sign Type:
 Wall Sign
 Quality:
 One Sign

Date : 2/11/2026
 Revision: R-0
 This design presentation is the property of Spiral Signs. All rights to use, alter or reproduce are prohibited without written permission.

Client Approved
 Landlord Approved

Note: _____

